

HARDIN MARINE

PART NUMBER: 625-8180

DESCRIPTION:
SERPENTINE DRIVE KIT w/SINGLE STAGE STAINLESS BODY SEA PUMP

HARDIN MARINE TECH LINE:
EAST COAST 386-445-2500
WEST COAST 707-585-9006
www.hardin-marine.com

THE CROSSOVER COMES PRE ASSEMBLED WITH ALL IDLERS IN PLACE. REMOVE THE (4) 1/4-20 BOLTS TO REMOVE COVER TO BASE. APPLY GREASE TO O-RING AND INSTALL BETWEEN COVER AND BODY. APPLY RED LOCTITE AND TORQUE 1/4-20 BOLTS TO 120 IN. LB.. PLACE O-RINGS BETWEEN BODY AND BLOCK WITH GREASE. APPLY SEALER TO 3/8 BOLTS AND TORQUE TO 30 FT. LB...

PULL SEA PUMP AWAY FROM CRANK PULLEY. THESE BOLT & WASHER BOLT THE SEA PUMP TO BLOCK. TORQUE 40-45 FT. LB... SLIDE CLAMP ON BRACKET TILL IT IS UP AGAINST THE HAT WASHER ON THE BRACKET.

SEA PUMP IS SUPPLIED WITH 1" NPT INLET/OUTLET & PULLEY INSTALLED.

THIS SPACER IS INSTALLED BETWEEN THE SEA PUMP ADJUSTING BRACKET AND CROSSBAR. THE BOLT IS INSTALLED IN PLACE FROM THE FACTORY.

WE SUPPLY BOTH 3/8-16 & 3/8-24 THREAD FOR BOLTING THE CRANK PULLEY TO EITHER A STOCK OR AFTERMARKET DAMPER. CHECK DAMPER FOR PROPER THREAD PITCH. APPLY RED LOCTITE & TORQUE 30-35 FT. LBS..

APPLY RED LOCTITE & TORQUE 70-75 FT. LBS..

THIS CAP IS FOR USE WITH NON SUPERCHARGED ENGINES. INSTALL AFTER CRANK PULLEY IS INSTALLED.

APPLY RED LOCTITE & TORQUE 30-35 FT. LBS..

INSTALL COURSE THREAD SIDE OF STUD INTO ENGINE BLOCK. SLIDE SPACER AND ALTERNATOR BRACKET. INSTALL 7/16-14 x 2" LONG BOLT AND WASHER IN LOWER BOLT HOLE IN ALTERNATOR BRACKET. SLIDE SPACER INTO PULLEY AND SLIDE OVER THE STUD. APPLY LOCTITE AND TORQUE NUT TO 45 FT. LB.. THIS IDLER ASSEMBLY COMES INSIDE THE CROSSOVER KIT.

THIS SPACER SITS BETWEEN THE ENGINE BLOCK AND ALTERNATOR BRACKET. THE SPACER, BOLT AND WASHER COMES INSIDE THE ALTERNATOR BRACKET KIT.

PULLEY IS INSTALLED ON ALTERNATOR AT THE FACTORY.

THE SINGLE WIRE ALTERNATOR REQUIRES ONE RED WIRE TO BE RUN FROM THE BATTERY LEAD ON STARTER TO THE REAR OF ALTERNATOR. THE TAB ON THE SIDE IS FOR GROUND EITHER TO BLOCK OR BACK TO THE STARTER.

THE DAMPER FACE, IS ENGINEERED TO SIT 3.095 FROM TIMING COVER MOUNTING FACE. DUE TO VARIOUS TIMING CHAIN OR BELT GEARS. IT MAYBE NECESSARY TO MACHINE THE DAMPER SNOUT TO ACHIEVE THIS 3.095 DISTANCE. DO NOT MACHINE THIS FACE.

MACHINE THIS FACE IF NECESSARY.

ITEM	QTY.	PART NO.	DESCRIPTION
1	1	625-4375	SINGLE INLET CROSSOVER
2	1	90043AN-STSS	WASHER - FLAT - SS - 7/16 AN
3	1	90043C150HHS	BOLT - HHCS - SS - 7/16-14x1-1/2
4	1	62541120022420	STAINLESS SINGLE STAGE SEA PUMP
5	1	625-4055	PULLEY, SERPENTINE
6	1	625-8176	PULLEY, CRANK - SERPENTINE
7	1	90050AN-STSS	WASHER - FLAT - SS - 1/2 AN
8	3	90037C150SH8	BOLT - SHCS - G8 - 3/8-16x1-1/2
9	1	90050F200HH8	BOLT - HHCS - G8 - 1/2-20x2"

ITEM	QTY.	PART NO.	DESCRIPTION
10	1	625-3132	BRACKET, CROSS SUPPORT
11	1	625-2304	BELT, SERPTINE - NON POWER STEERING
12	1	620-3147M-NC	ALTERNATOR, 90 AMP SINGLE WIRE CHROME
13	1	625-3130	PULLEY, ALTERNATOR - SERPENTINE
14	1	625-3111	BOTTOM MOUNT ALTERNATOR BRACKET - BLACK
15	1	625-3137	SPACER, ALTERNATOR BRACKET
16	1	625-8177	COVER, CRANK PULLEY
17	3	90037F075SHS	BOLT - SHCS - SS - 3/8-24x3/4
18	3	90037F150SH8	BOLT - SHCS - G8 - 3/8-24x1-1/2

HARDIN MARINE

PART NUMBER: 625-8181

DESCRIPTION:
SERPENTINE DRIVE KIT w/SINGLE STAGE STAINLESS BODY SEA PUMP
& POWER STEERING PUMP

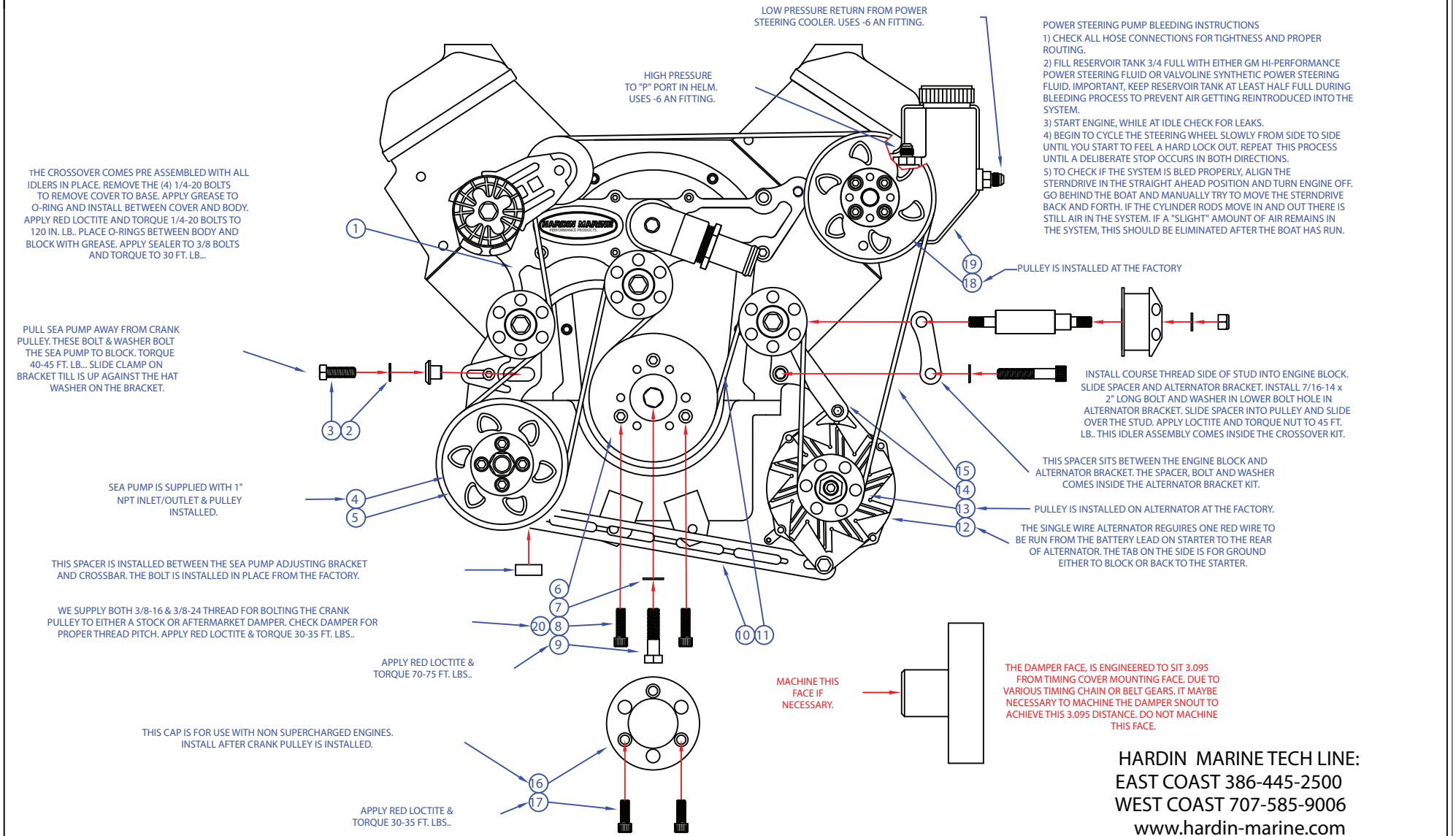

HARDIN MARINE TECH LINE:
EAST COAST 386-445-2500
WEST COAST 707-585-9006
www.hardin-marine.com

ITEM	QTY.	PART NO.	DESCRIPTION
1	1	625-4375	SINGLE INLET CROSSOVER
2	1	90043AN-STSS	WASHER - FLAT - SS - 7/16 AN
3	1	90043C150HHS	BOLT - HHCS - SS - 7/16-14x1-1/2
4	1	62541120022420	STAINLESS SINGLE STAGE SEA PUMP
5	1	625-4055	PULLEY, SERPENTINE
6	1	625-8176	PULLEY, CRANK - SERPENTINE
7	1	90050AN-STSS	WASHER - FLAT - SS - 1/2 AN
8	3	90037C150SH8	BOLT - SHCS - G8 - 3/8-16x1-1/2
9	1	90050F200HH8	BOLT - HHCS - G8 - 1/2-20x2"
10	1	625-3132	BRACKET, CROSS SUPPORT

ITEM	QTY.	PART NO.	DESCRIPTION
11	1	625-2107	BELT, SERPTINE w/ POWER STEERING
12	1	620-3147M-NC	ALTERNATOR, 90 AMP SINGLE WIRE CHROME
13	1	625-3130	PULLEY, ALTERNATOR - SERPENTINE
14	1	625-3111	BOTTOM MOUNT ALTERNATOR BRACKET - BLACK
15	1	625-3137	SPACER, ALTERNATOR BRACKET
16	1	625-8177	COVER, CRANK PULLEY
17	3	90037F075SHS	BOLT - SHCS - SS - 3/8-24x3/4
18	1	625-8197	POWER STEERING PULLEY KIT
19	1	625-8170	HEAD MOUNT POWER STEERING PUMP
20	3	90037F150SH8	BOLT - SHCS - G8 - 3/8-24x1-1/2"

HARDIN MARINE

PART NUMBER: 625-8182

DESCRIPTION:
SERPENTINE DRIVE KIT w/DUAL STAGE STAINLESS BODY SEA PUMP

HARDIN MARINE TECH LINE:
EAST COAST 386-445-2500
WEST COAST 707-585-9006
www.hardin-marine.com

THE CROSSOVER COMES PRE ASSEMBLED WITH ALL IDLERS IN PLACE. REMOVE THE (4) 1/4-20 BOLTS TO REMOVE COVER TO BASE. APPLY GREASE TO O-RING AND INSTALL BETWEEN COVER AND BODY. APPLY RED LOCTITE AND TORQUE 1/4-20 BOLTS TO 120 IN. LB.. PLACE O-RINGS BETWEEN BODY AND BLOCK WITH GREASE. APPLY SEALER TO 3/8 BOLTS AND TORQUE TO 30 FT. LB...

PULL SEA PUMP AWAY FROM CRANK PULLEY. THESE BOLT & WASHER BOLT THE SEA PUMP TO BLOCK. TORQUE 40-45 FT. LB... SLIDE CLAMP ON BRACKET TILL IS UP AGAINST THE HAT WASHER ON THE BRACKET.

SEA PUMP IS SUPPLIED WITH 1-1/4 NPT COMMON FRONT INLET, (2) 1" NPT OUTLET & PULLEY INSTALLED AS STANDARD. OTHER COMBINATIONS ARE AVAILABLE.

THIS SPACER IS INSTALLED BETWEEN THE SEA PUMP ADJUSTING BRACKET AND CROSSBAR. THE BOLT IS INSTALLED IN PLACE FROM THE FACTORY.

WE SUPPLY BOTH 3/8-16 & 3/8-24 THREAD FOR BOLTING THE CRANK PULLEY TO EITHER A STOCK OR AFTERMARKET DAMPER. CHECK DAMPER FOR PROPER THREAD PITCH. APPLY RED LOCTITE & TORQUE 30-35 FT. LBS..

APPLY RED LOCTITE & TORQUE 70-75 FT. LBS..

THIS CAP IS FOR USE WITH NON SUPERCHARGED ENGINES. INSTALL AFTER CRANK PULLEY IS INSTALLED.

APPLY RED LOCTITE & TORQUE 30-35 FT. LBS..

INSTALL COURSE THREAD SIDE OF STUD INTO ENGINE BLOCK. SLIDE SPACER AND ALTERNATOR BRACKET. INSTALL 7/16-14 x 2" LONG BOLT AND WASHER IN LOWER BOLT HOLE IN ALTERNATOR BRACKET. SLIDE SPACER INTO PULLEY AND SLIDE OVER THE STUD. APPLY LOCTITE AND TORQUE NUT TO 45 FT. LB.. THIS IDLER ASSEMBLY COMES INSIDE THE CROSSOVER KIT.

THIS SPACER SITS BETWEEN THE ENGINE BLOCK AND ALTERNATOR BRACKET. THE SPACER, BOLT AND WASHER COMES INSIDE THE ALTERNATOR BRACKET KIT.

PULLEY IS INSTALLED ON ALTERNATOR AT THE FACTORY.

THE SINGLE WIRE ALTERNATOR REQUIRES ONE RED WIRE TO BE RUN FROM THE BATTERY LEAD ON STARTER TO THE REAR OF ALTERNATOR. THE TAB ON THE SIDE IS FOR GROUND EITHER TO BLOCK OR BACK TO THE STARTER.

THE DAMPER FACE, IS ENGINEERED TO SIT 3.095 FROM TIMING COVER MOUNTING FACE. DUE TO VARIOUS TIMING CHAIN OR BELT GEARS. IT MAYBE NECESSARY TO MACHINE THE DAMPER SNOUT TO ACHIEVE THIS 3.095 DISTANCE. DO NOT MACHINE THIS FACE.

MACHINE THIS FACE IF NECESSARY.

ITEM	QTY.	PART NO.	DESCRIPTION
1	1	625-4375	SINGLE INLET CROSSOVER
2	1	90043AN-STSS	WASHER - FLAT - SS - 7/16 AN
3	1	90043C150HHS	BOLT - HHCS - SS - 7/16-14x1-1/2
4	1	62541220024430	STAINLESS DUAL STAGE SEA PUMP
5	1	625-4055	PULLEY, SERPENTINE
6	1	625-8176	PULLEY, CRANK - SERPENTINE
7	1	90050AN-STSS	WASHER - FLAT - SS - 1/2 AN
8	3	90037C150SH8	BOLT - SHCS - G8 - 3/8-16x1-1/2
9	1	90050F200HH8	BOLT - HHCS - G8 - 1/2-20x2"

ITEM	QTY.	PART NO.	DESCRIPTION
10	1	625-3132	BRACKET, CROSS SUPPORT
11	1	625-2107	BELT, SERPTINE - NON POWER STEERING
12	1	620-3147M-NC	ALTERNATOR, 90 AMP SINGLE WIRE CHROME
13	1	625-3130	PULLEY, ALTERNATOR - SERPENTINE
14	1	625-3111	BOTTOM MOUNT ALTERNATOR BRACKET - BLACK
15	1	625-3137	SPACER, ALTERNATOR BRACKET
16	1	625-8177	COVER, CRANK PULLEY
17	3	90037F075SH5	BOLT - SHCS - SS - 3/8-24x3/4
18	3	90037F150SH8	BOLT - SHCS - G8 - 3/8-24x1-1/2

HARDIN MARINE

PART NUMBER: 625-8183

DESCRIPTION:
SERPENTINE DRIVE KIT w/DUAL STAGE STAINLESS BODY SEA PUMP & POWER STEERING PUMP

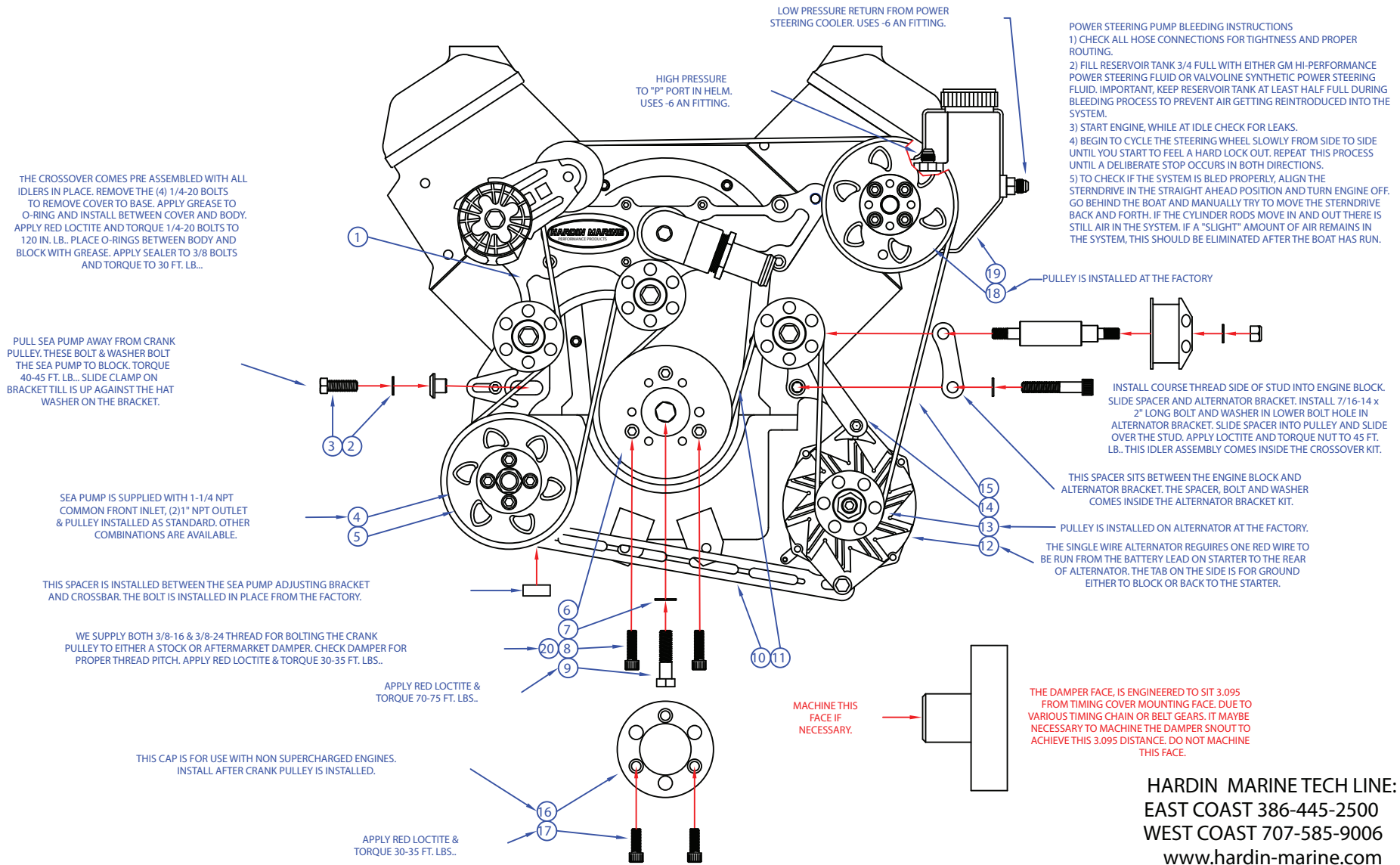

HARDIN MARINE TECH LINE:
EAST COAST 386-445-2500
WEST COAST 707-585-9006
www.hardin-marine.com

ITEM	QTY.	PART NO.	DESCRIPTION
1	1	625-4375	SINGLE INLET CROSSOVER
2	1	90043AN-STSS	WASHER - FLAT - SS - 7/16 AN
3	1	90043C150HHS	BOLT - HHCS - SS - 7/16-14x1-1/2
4	1	62541220024430	STAINLESS DUAL STAGE SEA PUMP
5	1	625-4055	PULLEY, SERPENTINE
6	1	625-8176	PULLEY, CRANK - SERPENTINE
7	1	90050AN-STSS	WASHER - FLAT - SS - 1/2 AN
8	3	90037C150SH8	BOLT - SHCS - G8 - 3/8-16x1-1/2
9	1	90050F200HH8	BOLT - HHCS - G8 - 1/2-20x2"
10	1	625-3132	BRACKET, CROSS SUPPORT

ITEM	QTY.	PART NO.	DESCRIPTION
11	1	625-2108	BELT, SERPTINE - w/ POWER STEERING
12	1	620-3147M-NC	ALTERNATOR, 90 AMP SINGLE WIRE CHROME
13	1	625-3130	PULLEY, ALTERNATOR - SERPENTINE
14	1	625-3111	BOTTOM MOUNT ALTERNATOR BRACKET - BLACK
15	1	625-3137	SPACER, ALTERNATOR BRACKET
16	1	625-8177	COVER, CRANK PULLEY
17	3	90037F075SHS	BOLT - SHCS - SS - 3/8-24x3/4
18	1	625-8197	POWER STEERING PULLEY KIT
19	1	625-8170	HEAD MOUNT POWER STEERING PUMP
20	3	90037F150SH8	BOLT - SHCS - G8 - 3/8-24x1-1/2