



CAPTAIN'S CALL ELECTRIC DIVERTER WIRING INSTRUCTIONS

1.

Your wiring kit includes a universal circuit breaker bracket that is designed for use on any application.

Refer to the illustrations at right for assembling the bracket to best suit your particular application. Bracket extension, nut, bolt and washer included.

2.

Installation of the new solid state wiring harness is done with a few simple connections as follows:

Route all wires carefully as to avoid contact with or come in close proximity to any item that may get extremely hot. Example: Where exhaust manifold mates to engine.

The positive (RED) wire is secured to the positive terminal on top of the starting battery.

The negative (BLACK) wire is secured to the ground on the rear of the engine. You can follow the negative (BLACK) wire from the battery to help you locate the ground connection.

NOTE: The ground post must be clean prior to installation. A faulty ground will cause the harness to fail and/or become extremely hot. Make sure the grounding nut is tight before operating system.

The LONG RED wire is connected to an auxiliary panel switch at the helm. If possible, this switch should be activated by the ignition. Should the diverters be inadvertently left on, with the motor off, this will prevent draining of battery power.

3.

Lastly, connect the wiring harness to the diverter solenoids. Do not remove large zip ties from wire-loop on solenoid, unless extra length of wire from the solenoid to the harness is required. Your installation is now complete.

CAUTION!

Fully read and understand wiring instructions before installing.

Connection of the Positive lead to a Negative source will cause permanent damage to the product and void the warranty.

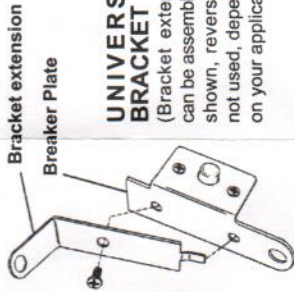

UNIVERSAL BRACKET
(Bracket extension can be assembled as shown, reversed or not used, depending on your application.)

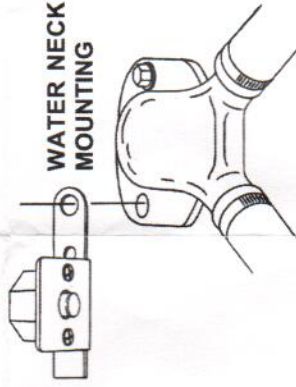

WATER NECK MOUNTING

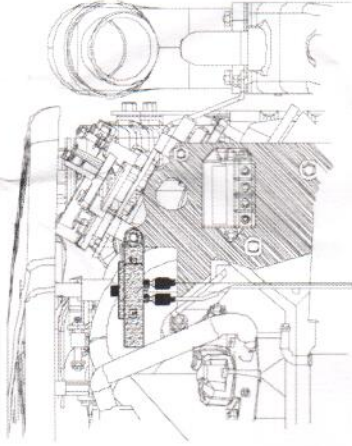

Mercury 8.1L Mount to Rear Lifting Bracket Rear View

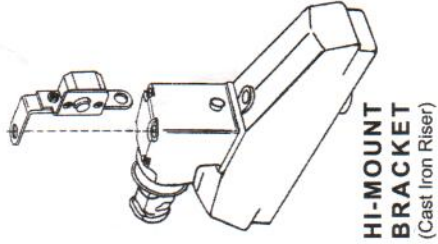

HI-MOUNT BRACKET
(Cast Iron Riser)

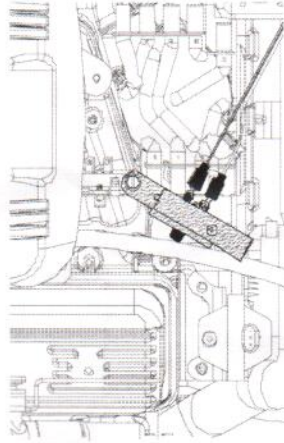

Mercury 5.0/5.7/6.2 Mount to Engine Circuit Breaker Top View

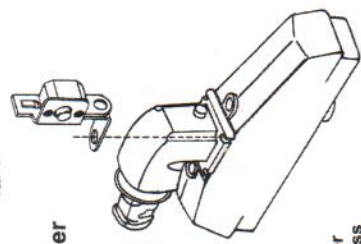

LOW-MOUNT BRACKET
(Stainless Steel Riser)

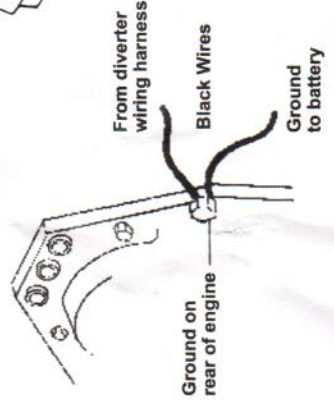

RED wire from wiring harness

To ground on engine

Ground on rear of engine

From diverter wiring harness

Black Wires

Ground to battery

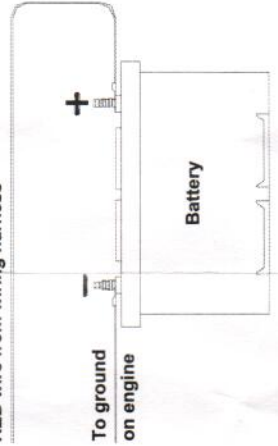

Battery